

BOOK 1150-155

Name and
Post Office Address
of Grantor: M. L. Lanford
206 Chestnut Avenue
Greer, S. C. 29651

Total
Line
for
Exchange Line
tributary to: Greer, South Carolina

The Property is bounded where the line enters and leaves this property by the property of:
O. F. Jones on the North
Chestnut Avenue on the South

Authority: C-6867 Classification: R45C
State: South Carolina

Approved: District Manager - Distribution

NORTH



TAX MAP T-18.2
BLOCK 1

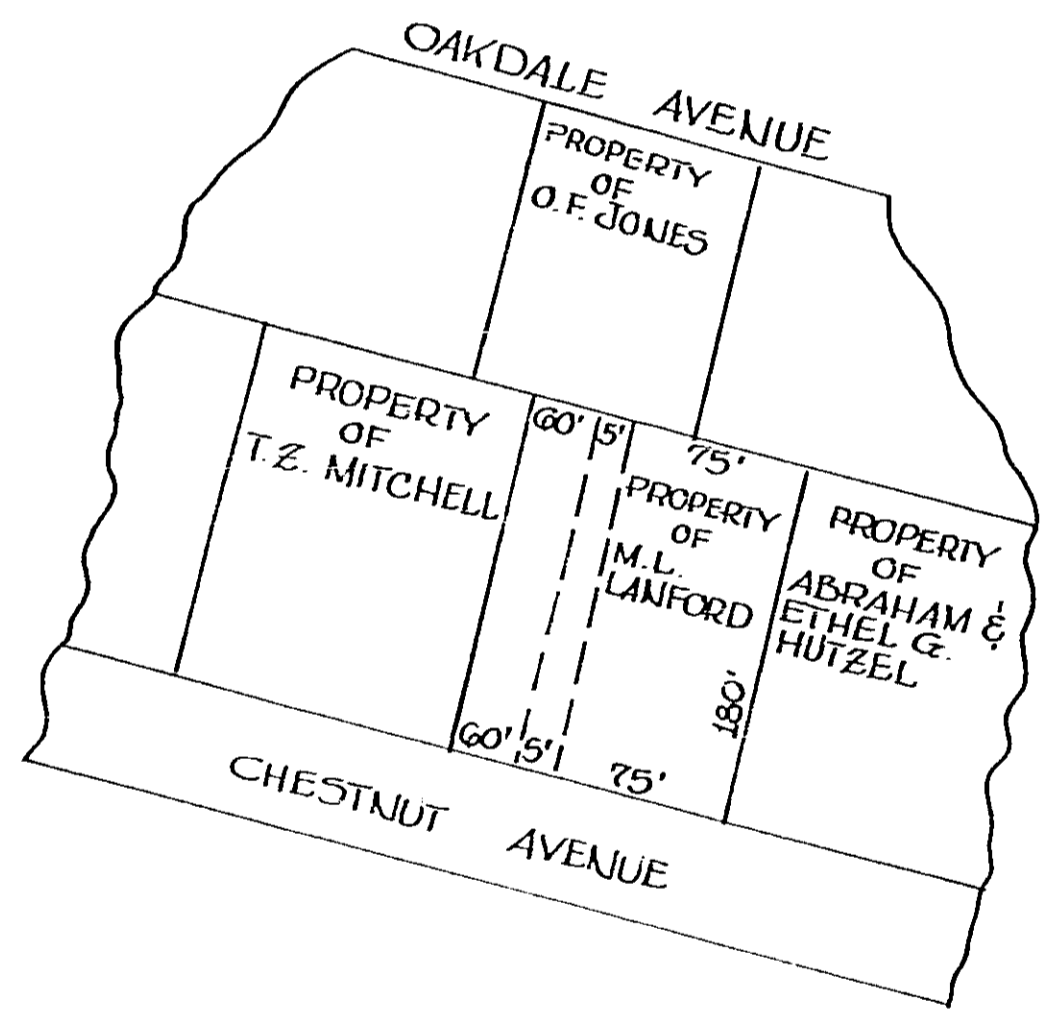

RECORDED JUN 17 1981 at 3:32 P.M. 31950

Filed for record in the office of
the R. M. C. for Greenville
County, S. C. at 3:32 o'clock
P.M. Jun. 17, 19 81
and recorded in Deed Book
1150 at page 157.

R. M. C. for G. Co. S. C.

31950
XX
1981 JUN 17 3:32 PM

4328 RV.2